



SOUTHTECH

STEEL MANUFACTURING CORP.



"What's in-store matters most"

SOUTHTECH STEEL MANUFACTURING CORPORATION, a local fabricator and distributor of imported racking system was introduced to the market in 2012, has set a modern plant facilities and highest rated equipment like its own state of the art powder coating facilities to respond to the increasing demand of racking system and structural needs all over the country. Situated at the heart of Carmona, Cavite, SMMC guarantees both accessibility and security. We take pride in our outstanding quality products; and our specialized, efficient and responsive staff who will facilitate your needs even after sales. Our long range of products includes Selective Racking System, Drive-in Racks, Cantilever Racks and Long Span Racks. We also provide Rack Supported Mezzanine, Slotted Shelving, Gondola Shelving and Steel Structures. At SSMC, we commit ourselves to professionalism and excellent service. We say, *"What's in-store matters most"*, as our service standard is to be able to save your space, time and money in just the exact way you have imagined.

Our Vision

Here at Southtech Steel Manufacturing Corporation, we do our best to satisfy the things that are expected of us. With this commitment and perseverance, we want to see and feel that we have done our job well and that we are able to assist our customers by providing our products and services. We also envision growing to the best we can be along with our customers and the society by giving them a place to "store".

Our Mission

Everyday, our work leads to one thing that matters: providing our clients the lift and support they need. We do this through our racking systems, steel structures and services with its various features to meet each client demands. We make it a point to give full commitment to our clients, who are in their own right are companies who are hardworking, committed, and responsible in working for their own goals and for society. We aim to work in hand with them, to grow, succeed, and fulfil our duties.

Our Products

HEAVY DUTY & LIGHT DUTY RACKING SYSTEM

DRIVE-IN RACKING SYSTEM



- Applicable for bulk use or cold storage warehouse
- Storage rack configurations that allow the forklift to drive directly into the lane of stacked rows (called a bay).
- Works on LIFO (last-in-first-out)

SELECTIVE RACKING SYSTEM



- Can accommodate any capacity requirements.
- Provides direct access to all stored pallets giving you the advantage of handling pallets without the need to move others.
- Works of FIFO (first-in-first-out) products at all times

LONGSPAN RACKING SYSTEM



- Is a good solution for storage of light to medium duty loads
- Possible for items in boxes or loose items that are deposited and withdrawn manually.
- Decking can be steel, plywood or wire mesh

CANTILEVER RACKING SYSTEM

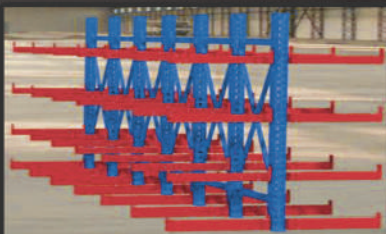

- This system allows storage of long-length stock and is perfect for outdoor or indoor facilities and work sites.
- Flexible for single and double sided application

TIRE RACKS



- Racking used for tires
- Can carry based on tires actual weight
- Beams are adjustable based on client's desired height

RACK SUPPORTED MEZZANINE



- Mezzanine floor is supported by racks
- Mezzanine floor can be used as office area or for bulk items
- Supporting racks can be either palletized or non-palletized items

KNOCKDOWN MEZZANINE



- Provide highest possible storage location in a limited space with sufficient space height. Accessible through staircase and loading gates with safety handrails. Mezzanine floor is supported by racks. Mezzanine floor can be used as office area.

SLOTTED SHELVING



- Can carry loads up to 250 kgs per level
- Assembly is easy – no special tools required
- Decking can be steel, plywood or wire mesh

CUSTOMIZED RACKING SYSTEM



- Racks are based on Customer's given design

RACKS ACCESSORIES



RACK COMPONENTS & SPECIFICATION

RACK SPECIFICATION

- Powder coated or wet paint for paint finish
- Upright frame can be bolted or welded
- Load beams can be boxed or step beam

1. Upright Frame
2. Upright Column
3. Brace
4. Base Plate
5. Load Beam
6. Load Beam Connector
7. Drop -in Crossbar
8. Plywood with Crossbar
9. Steel Deck
10. Row Spacer
11. Column Protector
12. Upright Frame Protector

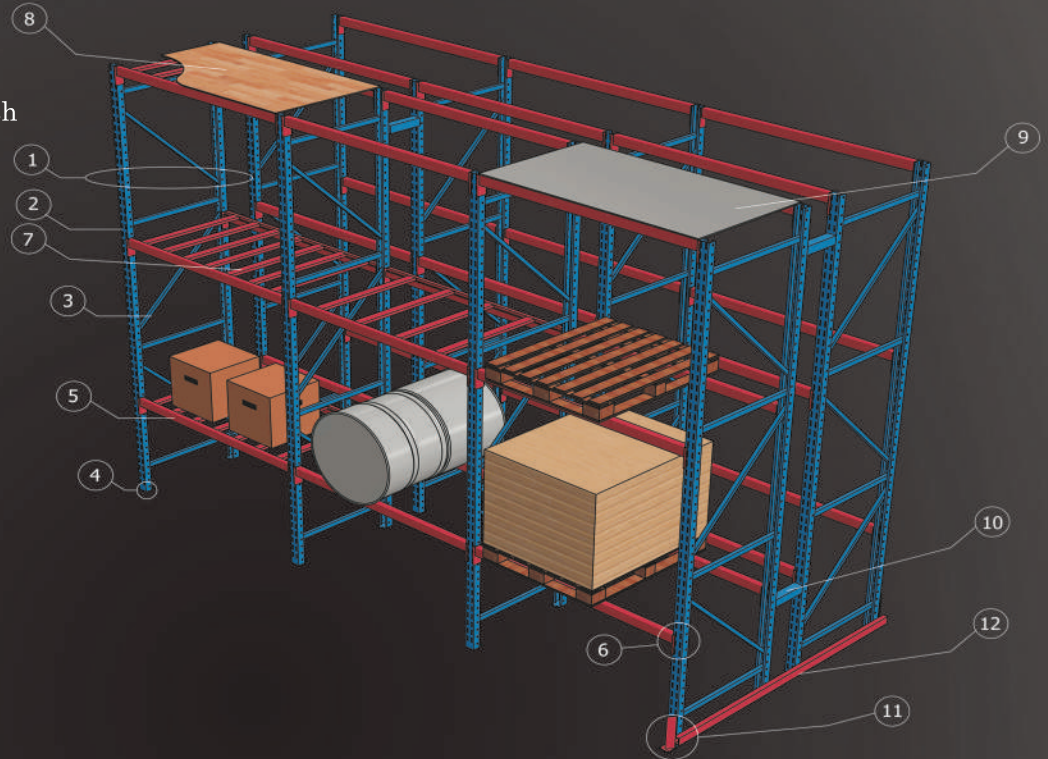

OTHER PRODUCTS AND SERVICES

- Shearing and bending of steel plates up to 6mm thickness
- Dismantling, relocation and re-installation of storage racking system
- Repair / retrofitting of storage racking system
- Fabrication of miscellaneous steel structures
- Powdercoating Services

AFTER SALES SERVICE

- We Conduct periodic inspection of all completely installed racks.

Our Location:

Main Office: Unit 2106 Entrata Tower 1 Condominium
2609 Civic Drive, Filinvest City Alabang,
Muntinlupa City
Tel. No. (02)553-6633 / (0932)-859-8331
Website: www.southtechsteelrack.com
Email address: southtechsmc@yahoo.com

Plant Office: Bldg D-1 Granville Industrial Complex,
Brgy. Bancal, Carmona, Cavite City
Tel. No. (046)413-0108 / (0932)-859-8428

